

CÉRÀGRÈS
LUXE

ABSOLUTE



Absolute è un materiale di design in gres porcellanato. La superficie geometrica in porcellana cattura l'occhio con la sua sorprendente tavolozza di colori e l'affascinante design astratto. Realizzata con la porcellana più pregiata, questa piastrella emana un'eleganza moderna e raffinata che esalta qualsiasi spazio. Le tonalità dominanti di grigio antracite intenso e nero inchiostro creano un'atmosfera sofisticata e malinconica, punteggiata da audaci lampi di vivido azzurro. Il motivo geometrico danza sulla superficie della piastrella, forme geometriche che si incastrano e si sovrappongono in un'esposizione dinamica, quasi cinetica. Linee e angoli netti si intrecciano per formare composizioni intricate e astratte che attirano lo sguardo, invitando a un'ispezione più ravvicinata per scoprire le sottili sfumature e le accattivanti asimmetrie all'interno del design.

Absolute is a design material in porcelain stoneware. The geometric porcelain surface captivate the eye with their striking color palette and mesmerizing abstract design. Crafted from the finest porcelain, this tile exude a sleek, modern elegance that elevates any space. The dominant hues of deep charcoal grey and inky black create a sophisticated, moody ambiance, punctuated by bold flashes of vivid azure blue. The geometric pattern dance across the tile surface, geometric shapes interlocking and overlapping in a dynamic, almost kinetic display. Sharp lines and angles intertwine to form intricate, abstract compositions that draw the gaze, inviting closer inspection to uncover the subtle nuances and captivating asymmetries within the design.

Absolute est un matériau de design en grès cérame. La surface géométrique en porcelaine captive le regard avec sa palette de couleurs saisissantes et son design abstrait fascinant. Fabriqué à partir de la porcelaine la plus fine, ce carreau dégage une élégance épurée et moderne qui rehausse n'importe quel espace. Les teintes dominantes de gris anthracite profond et de noir d'encre créent une ambiance sophistiquée et maussade, ponctuée d'éclats audacieux de bleu azur vif. Le motif géométrique danse sur la surface du carreau, les formes géométriques s'imbriquant et se chevauchant dans un affichage dynamique, presque cinétique. Des lignes et des angles nets s'entrelacent pour former des compositions complexes et abstraites qui attirent le regard, invitant à une inspection plus approfondie pour découvrir les nuances subtiles et les asymétries captivantes du design.

Absolute es un material de diseño en gres porcelánico. La superficie geométrica de porcelana cautiva la vista con su sorprendente paleta de colores y su fascinante diseño abstracto. Elaborada con la mejor porcelana, esta baldosa exuda una elegancia elegante y moderna que realza cualquier espacio. Los tonos dominantes de gris carbón profundo y negro tinta crean un ambiente sofisticado y melancólico, acentuado por destellos audaces de azul celeste intenso. El patrón geométrico baila sobre la superficie de la baldosa, las formas geométricas se entrelazan y superponen en una exhibición dinámica, casi cinética. Las líneas y los ángulos nítidos se entrelazan para formar composiciones abstractas e intrincadas que atraen la mirada, invitando a una inspección más cercana para descubrir los matices sutiles y las asimetrías cautivadoras dentro del diseño.

ABSOLUTE



Absolute 60x120

ABSOLUTE

Absolute 60x120



ABSOLUTE

Colori . Colours . Couleurs . Colores

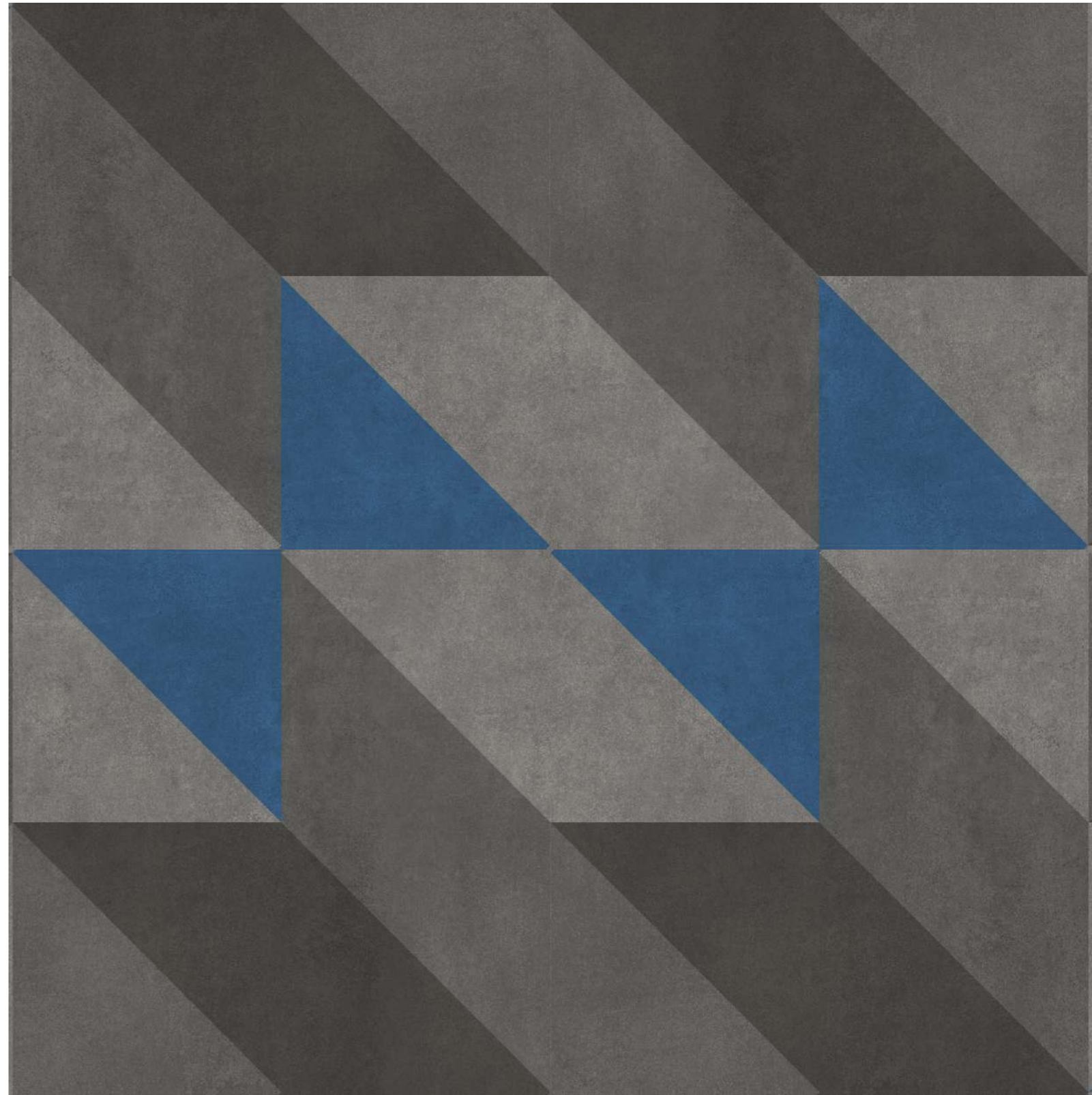

ABSOLUTE

Formati . Sizes . Formats . Formatos



60x120 R
24"x48"
772551 Absolute

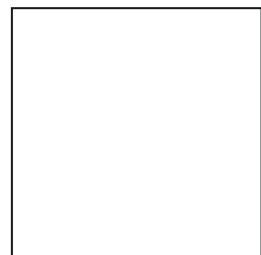

60x60 R
24"x24"
772552 Absolute



30x120 R
12"x48"
772553 Absolute

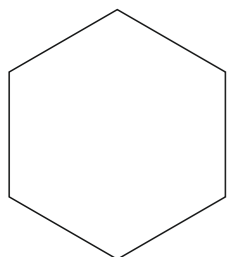

52.5x60 R
21"x24"
772554 Absolute

ABSOLUTE

Formati . Sizes . Formats . Formatos



60x120 R
24"x48"
772551 Absolute



60x60 R
24"x24"
772552 Absolute



30x120 R
12"x48"
772553 Absolute

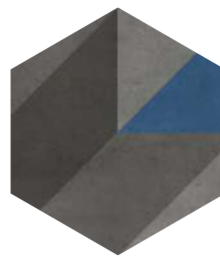

52.5x60 R
21"x24"
772554 Absolute

A81

A46

A71

A631



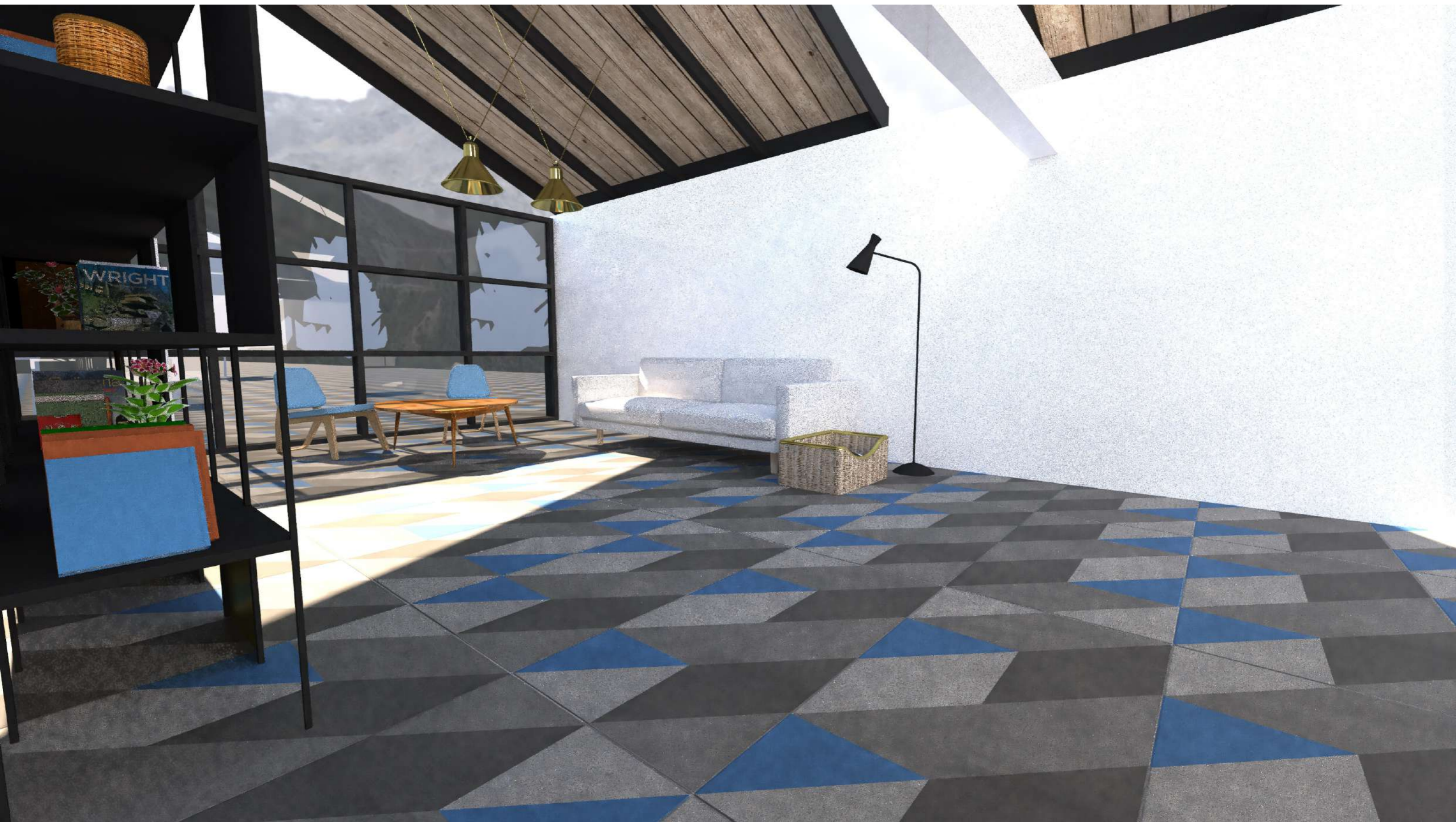

Si consiglia la posa con fuga 2 mm. - Laying with a 2 mm-joint is recommended. - Pose recommandée avec joints de 2 mm. - Se recomienda la colocación con juntas de 2 mm.



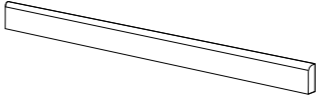

Pezzi speciali . Trims . Pièces spéciales . Formstücke . Piezas especiales .

| | | |
|----------|--|--|
| |  | |
| | BATTISCOPA | |
| | 100x1200 | |
| | A59A  | |
| ABSOLUTE | 772555 | |

Imballi . Packing . Conditionnement . Verpackungseinheiten . Embalajes .

| FORMATO SIZE FORMAT FORMAT FORMATO | SPESSORE THICKNESS EPAISSEUR STÄRKE ESPESOR | KG/MQ KG/SQM KG/MC KG/QM KG/MQ | SCATOLA BOX BOÎTE KARTON CAJA КОРБОККА | | EUROPALLET | |
|--|---|--|--|------|------------|-------|
| | | |  mq | box | mq | mq |
| 60x120 . 24"x48" | 9 mm . 0,35" | 30 | 2 | 1.43 | 32 | 45.82 |
| 60x60 . 24"x24" | 9 mm . 0,35" | 30 | 4 | 1.43 | 40 | 57.20 |
| 30x120 . 12"x48" | 9 mm . 0,35" | 30 | 4 | 1.43 | - | - |
| 52.5x60 . 21"x24" | 9 mm . 0,35" | 30 | 4 | 1.43 | - | - |

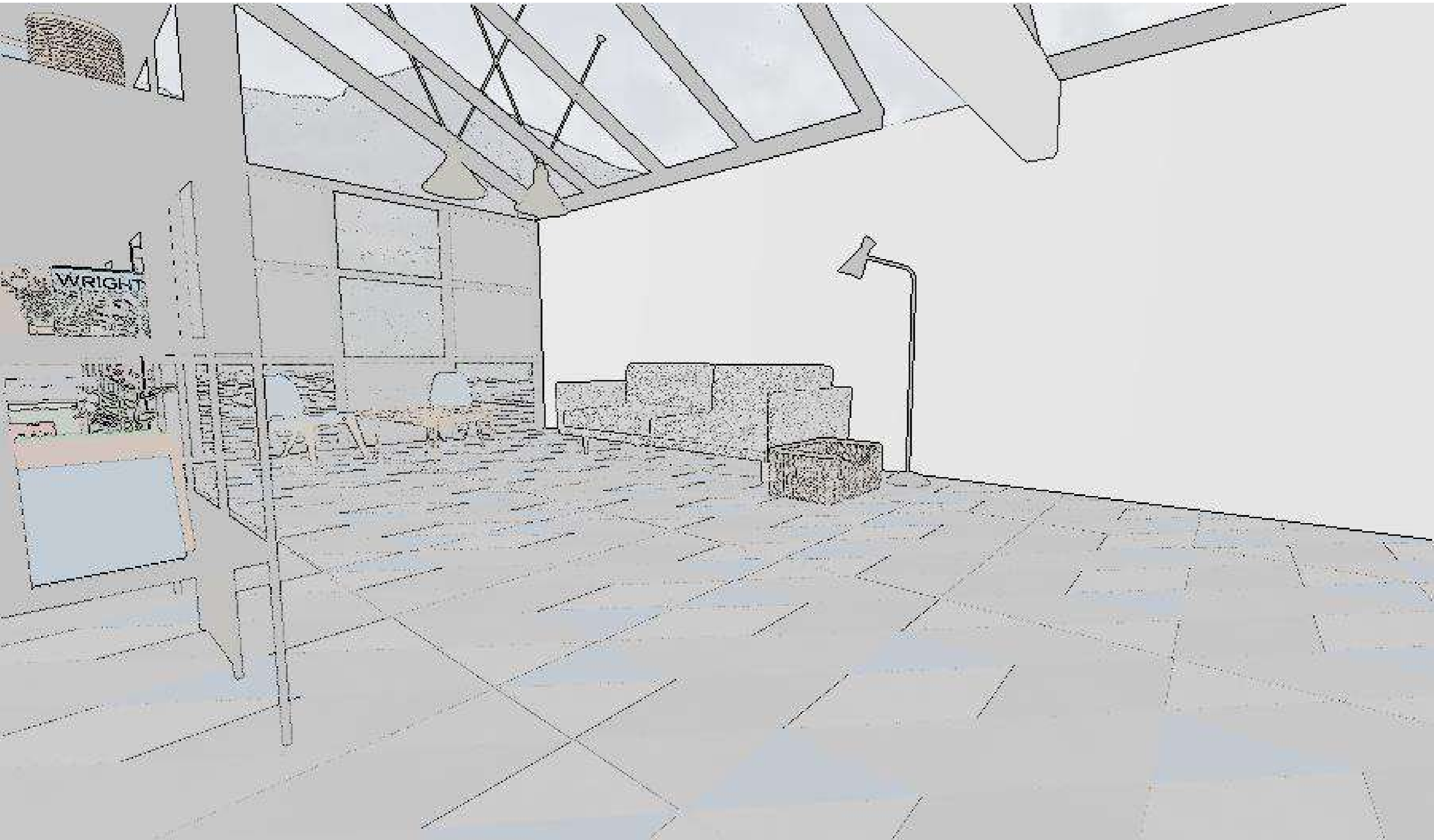











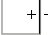

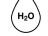

WRIGHT

CARATTERISTICHE TECNICHE

Technical specifications | Technische Eigenschaften | Caractéristiques techniques | Características técnicas |

STANDARD EN 14411 - G

| | CARATTERISTICHE TECNICHE TECHNICAL DATA TECHNISCHE DATEN CARACTERISTIQUES TECHNIQUES | NORMA STANDARD NORM NORME | VALORI PRESCRITTI DALLE NORME EN 14411 - G INTERNATIONAL STANDARDS EN 14411 - G INTERNATIONALE NORMWERTE EN 14411 - G VALEURS PREVUES PAR LES NORMES EN 14411 - G | VALORE MEDIO CERAGRES CERAGRES AVERAGE VALUE CERAGRES MITTELWERT VALEURS MOYEN CERAGRES |
|--|---|------------------------------------|--|--|
| | CARATTERISTICHE DIMENSIONALI - SIZE CHARACTERISTICS - MASSEIGENSCHAFTEN DETERMINATION DES CARACTERISTIQUES DIMENSIONNELLES - CARACTERÍSTICAS DIMENSIONALES - РАЗМЕРНЫЕ ХАРАКТЕРИСТИКИ - 尺寸特征 | | | NAT (UGL) |
|  | LATI SIDES - SEITEN COTES - CANTOS РАЗМЕРЫ СТОРОН - 側邊 | EN ISO 10545-2 | ± 0,3% MAX (± 1,0 mm MAX) | CONFORME COMPLYING |
|  | SPESSORE THICKNESS - DICKE ÉPAISSEUR - ESPESOR ТОЛЩИНА - 厚度 | EN ISO 10545-2 | ± 5,0% MAX (± 0,5 mm MAX) | CONFORME COMPLYING |
|  | RETTILINEITÀ DEGLI SPIGOLI STRAIGHTNESS OF SIDES - GERADLINIGKEIT DER KANTEN RECTITUDE DES ARETES - RECTITUD DE LOS CANTOS КОСУГОЛЬНОСТЬ - 邊角平直度 | EN ISO 10545-2 | ± 0,3% MAX (± 0,8 mm MAX) | CONFORME COMPLYING |
|  | ORTOGONALITÀ RECTANGULARITY - RECHTWINKLIGKEIT PERPENDICULARITÉ - ORTOGONALIDAD КРИБИЗНА СТОРОН - 直角度 | EN ISO 10545-2 | ± 0,3% MAX (± 1,5 mm MAX) | CONFORME COMPLYING |
|  | PLANARITÀ SURFACE FLATNESS - EBENFLÄCHIGKEIT PLANEITE DE SURFACE - PLANEIDAD КРИБИЗНА ЛИЦЕВОЙ ПОВЕРХНОСТИ - 平整度 | EN ISO 10545-2 | ± 0,4% MAX (± 1,8 mm MAX) | CONFORME COMPLYING |
|  | ASSORBIMENTO D'ACQUA WATER ABSORPTION - WASSERAUFNAHME ABSORPTION D'EAU - ABSORCIÓN DE AGUA ВОДОПОГЛОЩЕНИЕ - 吸水率 | EN ISO 10545-3 | ≤ 0,5% | ≤ 0,1% |
|  | RESISTENZA ALLA FLESSIONE FLEXION RESISTANCE - BIEGEFESTIGKEIT RESISTANCE A LA FLEXION - RESISTENCIA A LA FLEXIÓN ПРЕДЕЛ ПРОЧНОСТИ ПРИ ИЗГИБЕ - 抗弯强度 | EN ISO 10545-4 | S ≥ 700 N (< 7,5 mm) S ≥ 1.300 N (> 7,5 mm) R ≥ 35 N/mm². | S ≥ 2.800 N R ≥ 49 N/mm² (formato 600x600 24"x24" size) |
|  | RESISTENZA ALL'URTO IMPACT RESISTANCE - STOSSFESTIGKEIT RESISTANCE AUX CHOCES - RESISTENCIA A LOS GOLPES УДАРООСТОЙКОСТЬ - 抗冲击强度 | EN ISO 10545-5 | VALORE DICHIARATO DECLARED VALUE | > 0,80 |
|  | RESISTENZA ALL'ABRASIONE ABRASION RESISTANCE - ABRIEBFESTIGKEIT RESISTANCE A L'ABRASION - RESISTENCIA A LA ABRASIÓN СТОЙКОСТЬ К ИСТИРАНИЮ - 耐磨强度 | EN ISO 10545-6 | ≤ 175 mm³ | < 150 mm³ |
|  | COEFFICIENTE DI DILATAZIONE TERMICA LINEARE COEFFICIENT OF LINEAR THERMAL EXPANSION - LINEARER WÄRMEAUSSDEHNUNGSKOEFFIZIENT COEFFICIENT DE DILATATION THERMIQUE LINEAIRE - COEFICIENTE DE DILATACIÓN TÉRMICA LINEAL КОЭФФИЦИЕНТ ЛИНЕЙНОГО ТЕРМИЧЕСКОГО РАСШИРЕНИЯ - 线性热膨胀系数 | EN ISO 10545-8 | — | α=7,3x10 ⁻⁶ °C ⁻¹ |
|  | RESISTENZA AGLI SBALZI TERMICI RESISTANCE TO THERMAL SHOCKS - BESTÄNDIGKEIT GEGEN TEMPERATURSCHWANKUNGEN RESISTANCE AUX CHOCES THERMIQUES - RESISTENCIA A LOS CHOQUES TÉRMICOS СТОЙКОСТЬ К ПЕРЕПАДАМ ТЕМПЕРАТУРЫ - 耐热突变性 | EN ISO 10545-9 | TEST SUPERATO SECONDO EN ISO 10545-1 PASS ACCORDING EN ISO 10545-1 | NESSUN DANNO NO DAMAGE |
|  | RESISTENZA AL GELO FROST RESISTANCE - FROSTBESTÄNDIGKEIT RESISTANCE AU GEL - RESISTENCIA AL HIELO МОРОЗОСТОЙКОСТЬ - 耐冻性 | EN ISO 10545-12 | TEST SUPERATO SECONDO EN ISO 10545-1 PASS ACCORDING EN ISO 10545-1 | NESSUN DANNO NO DAMAGE |
|  | RESISTENZA ALL'ATTACCO CHIMICO RESISTANCE TO CHEMICALS - CHEMIKALIENBESTÄNDIGKEIT RESISTANCE A L'ATTAQUE CHIMIQUE - RESISTENCIA QUÍMICA ХИМИЧЕСКАЯ СТОЙКОСТЬ - 耐化学品作用 | EN ISO 10545-13 | UB MIN. | UA ULA UHA |
|  | RESISTENZA ALLE MACCHIE RESISTANCE TO STAINS - FLECKENBESTÄNDIGKEIT RESISTANCE AUX TACHES - RESISTENCIA A LAS MANCHAS УСТОЙЧИВОСТЬ К ПЯТНООБРАЗОВАНИЮ - 防污性 | EN ISO 10545-14 | VALORE DICHIARATO DECLARED VALUE | 5 |
|  | CESSIONE DI PIOMBO E CADMIO LEAD AND CADMIUM DISCHARGE - ABGABE VON BLEI UND CADMIUM PERTE DE PLOMB ET CADMIUM - CESIÓN DE PLOMO Y CADMIO ВЫДЕЛЕНИЕ СВИНЦА И КАДМИЯ - 铅和镉的排放 | EN ISO 10545-15 | VALORE DICHIARATO DECLARED VALUE | < AL LIMITE DI RILEVAMENTO < THAN INSTRUMENT LIMIT |
| | | | | NAT |
| | | DM. 236/89 BCRA | > 0,40 | > 0,40 |
| | | ASTM C1028 | SCOF > 0,60 | > 0,60 |
| | | ANSI A137.1 | Wet DCOF > 0,42 | > 0,42 |
| | | AS 4586:2013 | - | - |
| | | DIN 51130 | - | R9 |
| | | DIN 51097 | - | - |
| | | ENV 12633 | ≥ CL1 | CL1 |
| | | BS 7976 | ≥ 36 | ≥ 36 |
|  | SCIVOLOSITÀ SKID RESISTANCE - RUTSCHWERT GLISSANCE - ADHERENCIA | | | |



touch@ceragresceramics.com
www.ceragresceramics.com